



Way Ahead



Practice Sheet 8

a Mark (✓) the correct answer:

Yes

No

1. The duck is in the bath.

☐☐

2. The cat is on the table.

☐☐

3. This is a fridge.

☐☐

4. The toys are in the box.

☐☐

5. This is the living room.

☐☐

6. There is a man in the house.

☐☐

b Put these words in order:

1. next - bed - chair - the - is - to - The.

2. The - is - the - phone - on - table.

3. train - desk - My - under - is - the.

4. is - the - pencil - Where?



Way Ahead



Practice Sheet 8

c Complete the words:



L _ v _ n g r _ o m



f _ i d _ e



b a _ _



p _ o _ e



k _ _ c h e n



h o _ _ e

d Underline the correct word(s) in brackets:

1. _____ is the doll? It's on the desk.

(What - Where - How)

2. I'm _____ to Meg.

(on - between - next)

3. The teddy is _____ the table.

(on - between - next)

4. The car is _____ the chair.

(under - next - between)

5. The ball is _____ to the elephant.

(between - next - under)

6. Put your hand _____ your head.

(in - on - between)



Way Ahead



Practice Sheet 8

7. The hat is _____ the man's head.

(next - in - on)

8. Is the mouse _____ to the bed?

(next - between - on)

9. The man is _____ the house.

(in - next - between)

10. The milk is in the _____.

(fridge - bathroom - tank)

e Look at the picture and answer the questions:

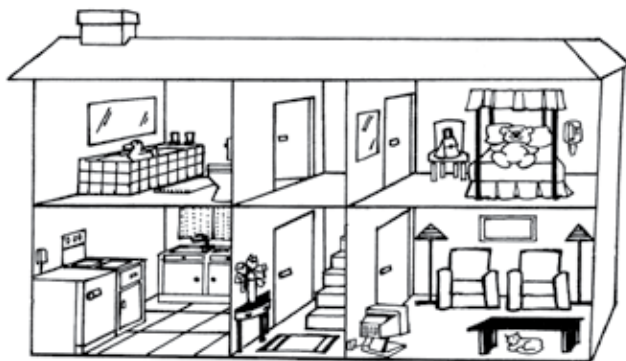

1. Where is the duck?

2. Is the cat in the kitchen?

3. Where is Jane's bag?

4. Where is the telephone?

5. Where is the rug?

6. Is the teddy in the bed room?



Way Ahead



Practice Sheet 8

f Match:

1. chair

☐



2. lamp

☐



3. clock

☐



4. mirror

☐



5. rug

☐



g Use in, on, between, under or next:

1. The chicken is _____ the fridge.

2. The chair is _____ to the door.

3. the vase is _____ the table.

4. the ball is _____ the bed.

5. Jane's bag is _____ the desk and the cupboard.